



NEW BRITAIN TOWNSHIP

207 Park Avenue • Chalfont, PA 18914 • Telephone: (215) 822-1391

ROAD OPENING/SIDEWALK PERMIT APPLICATION

Please Note:

Applicant To Complete All Items

TOWNSHIP USE ONLY

Permit #: _____
Date: _____
Payment: _____
Check #: _____
Receipt #: _____

Identification

1. Proposed Work At: _____ Lot#: _____
(Streets and Street Name) (If development, give Lot #)
2. Tax Parcel Number: _____
3. Name of Applicant: _____ Email: _____
Address: _____
City: _____ State: _____ Zip: _____
Phone (H): _____ Phone (W): _____
4. Name of Owner: _____
Mailing Address: _____
City: _____ State: _____ Zip: _____
Phone (H): _____ Phone (W): _____
5. Name of Contractor: _____
Address: _____
City: _____ State: _____ Zip: _____
Phone (H): _____ Phone (W): _____

Road Open Information

New Driveway Relocation Sidewalk Curb Replacement Utility Work OTHER: _____

DESCRIPTION OF WORK: (if more space is needed, attach additional sheets)

The applicant shall submit a general description of the proposed work and a list of materials for construction.

INSURANCE REQUIRED: All applicants must complete the attached insurance addendum for Workman's Compensation and provide proof of General Liability Insurance Prior to the issuance of any permit.

ROAD REPAIRS: If the work performed under this permit results in damage to any township roads or other township facilities, the Applicant shall immediately notify its insurance carrier. Applicant shall be responsible for all such damages and shall commence repairs within 10 days of notice from the Township.

PLOT PLAN: The applicant shall clearly identify the location of the construction. Also, a sketch indicating width and type of surface must be submitted with this application. ALL NEW DRIVEWAYS MUST BE PAVED AT LEAST FROM THE EXISTING ROAD TO THE R.O.W. LINE.

**Plot Plan
For Applicants Use**

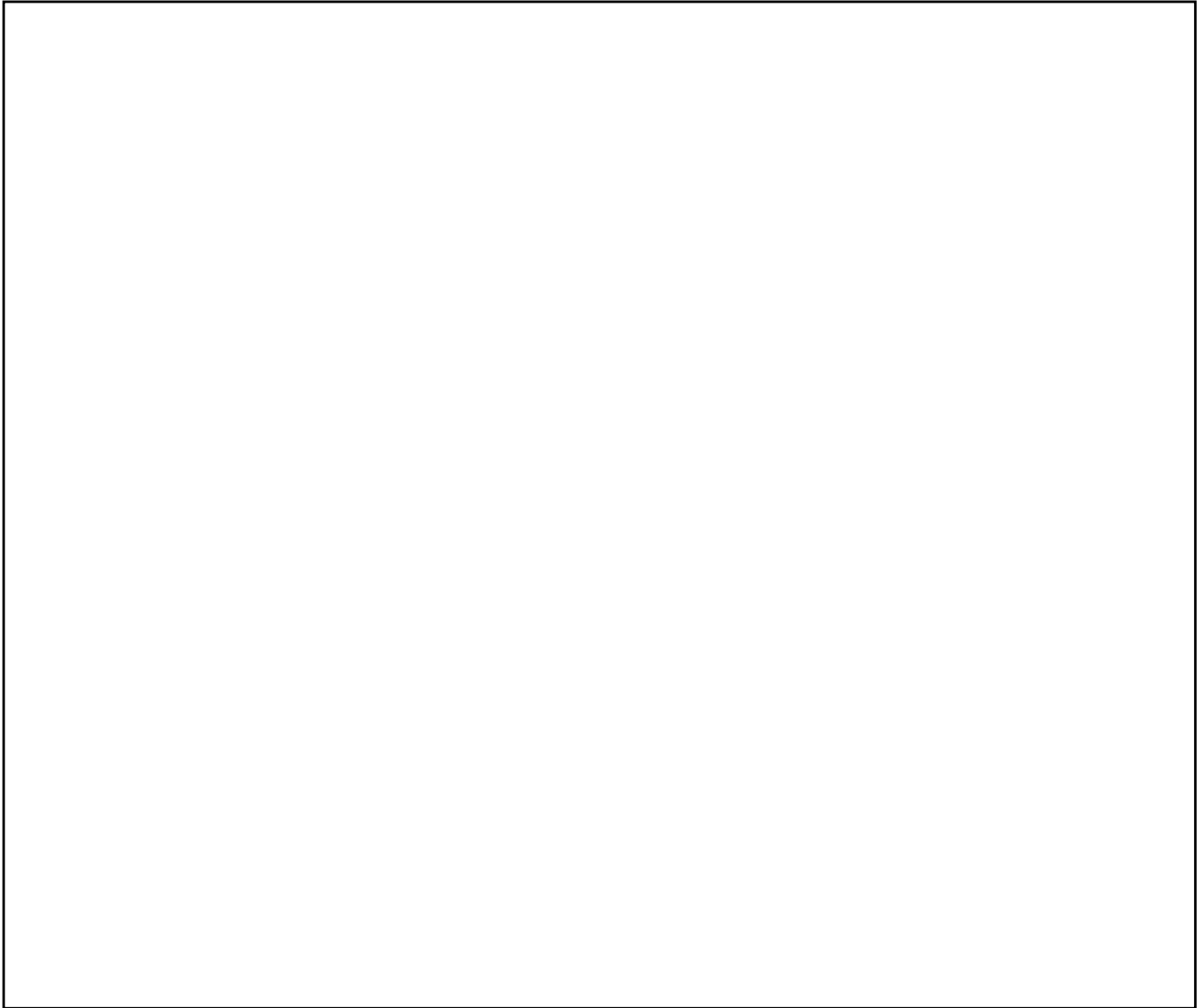

I hereby certify that the proposed work is authorized by the owner of record, and that I have be authorized by the owner to make this application as his/her authorized agent and that we agree to comply with all Township requirements for the above referenced work and understand that this is an application only, and that no work may begin until the actual permit for work issued by the Township.

Signature of Applicant: _____ Date: _____



New Britain Township Concrete Checklist for Sidewalk, Curb, and Driveway Apron and Depressions

Check off work to be completed and submit with permit application

Final Inspections must be scheduled 24 hours prior to pouring concrete.

Weekend pours are NOT permitted.

Concrete pours shall take place between 9:30am and 11:30 unless otherwise approved by Township.

No staging or storing of construction materials in the street is permitted without approval.

All streets are to be kept clean of all construction debris.

Lighted barricades, reflective cones and caution tape are required around all work areas.

**Please reference Detailed Concrete Specifications and Curb, Sidewalk, Apron details.*

Closed Permit Requirements

PA One Calls are required before construction begins for all excavations regardless of depth.

Concrete to be used is 4,000 psi air entrained concrete.

Copies of material tickets are to be supplied to the inspector.

Final inspection after all work is completed.

Curb Work

Best quality full depth steel or wood forms are to be used. Face forming on existing asphalt is not permitted.

Control Joints are to be placed every 10ft.

Curb shall be dowel pinned into inlets. Two #6 rebars centered vertically.

Depression Curb shall have two #6 rebars placed at midpoint of depressed curb per specs.

16" minimum saw cut into roadway to allow for face form installation and roadway restoration.

Backfill: 6" compacted 2A modified stone, 4" of 19mm base course, 2" 9.5mm Superpave wearing course.

1/2" Expansion material to be placed every 50 linear feet and at one end of isolated repairs.

Sidewalk Work

4 inches 2B clean stone to be placed and compacted under sidewalk with a vibrator compacter.

4 inches of 4,000 psi air entrained concrete.

1/2" Expansion material to be placed at the beginning and end of each isolated replacement section.

Non-slip surface texture shall be broomed transverse to the slope of the sidewalk.

1/2" Expansion material to be placed at a minimum of 20ft and a maximum of 30ft, and at each thickness transition from 4-inch to 6-inch (apron/sidewalk).

1/8" wide x 1" deep transverse contraction joint to be placed to make the sidewalk blocks equal in width to length, not to exceed 8ft in either dimension.

Apron Work

6 inches of 2B clean stone to be placed under apron and apron sidewalk and compacted with vibrator.

6 inches of 4,000 psi air entrained concrete.

1 layer of WWF 6x6 W2xW2 to be placed in the apron and apron sidewalk.

1/2" expansion material required between curb and apron and between apron and apron sidewalk.

Non-slip surface texture (broom finish) to be applied parallel with the direction of roadway on aprons only. Apron sidewalk to be perpendicular to the direction of sidewalk travel and consistent with 4-inch sidewalk.

Contractor Name: _____ Date: _____

Signature: _____

Site Address: _____

At final Inspection:

Township Signoff: _____ Date: _____

Addendum to Construction Permit

The applicant for the construction permit, pursuant PA Act 44 of 1993, submits:

Certificate of Insurance – complete Sections I, III, & IV

Certificate of Self-Insurance – complete Sections I, III, & IV.

Affidavit of Exemption – complete Sections II, III, & IV.

I. Attach the certificate of Insurance of Certificate of Self-insurance as proof of Worker's

Compensation. The municipality must be named as the "Certificate Holder". Please complete the following:

Name of Insurer _____

Address _____

City _____ State _____ Zip _____

Policy number _____ Expiration date _____

Name of Policyholder (Contractor) _____

Address _____

City _____ State _____ Zip _____

Federal or State employer identification number _____

1. This policy provides coverage for the requirements of the Worker's Compensation Act, the Occupational Disease Act, and where applicable, the Federal Longshore and Harbor Worker's Compensation Act.
2. The insurer has been notified that the municipality issuing the permit is to be named as a certificate holder.
3. Any subcontractors used on this project will be required to have Worker's Compensation Coverage.
4. The contractor/policyholder will notify the municipality of any change in status, cancellation or expiration of the policy.
5. Violation of the Worker's Compensation Act will result in the issuance of a "stop-work" order and/or any remedies allowed by law



II. If an exemption is claimed, complete the following:

Basis for exemption (check one)

Applicant is an individual who owns the property.

Contractor is a sole proprietorship without employees.

Contractor/Applicant is a corporation, and employees working on the project qualify as "executive employees" under section 104 of the Worker's Compensation Act.

All of the contractor's employees are exempt on religious grounds under section 304.2 of the Worker's Compensation Act (attach an explanatory sheet).

Other. (attach an explanatory sheet)

1. Any subcontractors used on this project are required to carry Worker's Compensation Insurance.
2. The Applicant is not permitted to employ any individual to perform work on this project in violation of the act.
3. Violation of the Worker's Compensation Act will result in the issuance of a "stop-work" order and/or any remedies available to the municipality.

III. Name of applicant _____

Address _____

City _____ State _____ Zip _____

My signature on behalf of or as the contractor/applicant constitutes my verification that the statements contained here are accurate and true, otherwise I am subject to penalties of 18 Pa. C.S.A. 4904 relating to un-sworn falsifications to authorities.

IV.

Signature

Title

Print Name

Company Name

Revision 08/05/2024



PART 2

**STANDARDS FOR CONSTRUCTION OF DRIVEWAYS AND INSTALLATION
OF UTILITIES WITHIN STREET RIGHTS-OF-WAY**

§21-201. Purpose.

In accordance with the provisions of §2322 of the Second Class Township Code, Act 60 of 1995, as amended, no railroad or street railway shall be constructed upon any Township road, nor shall any railroad or street railway crossings, driveway connections, gas pipes, water pipes, electric conduits or other piping be laid upon or in, nor shall any telephone, telegraph or electric light or power poles or any coal tipples or any other obstructions be erected upon or in any portion of a Township road, except under conditions, restrictions and regulations specified in permits granted by the Township for that purpose.

(Ord. 02-05-03, 5/20/2002, §1)

§21-202. Applicability.

No person, firm, corporation or other entity within the Township shall construct a driveway or install a utility within a street right-of-way, except as permitted by this Part.

(Ord. 02-05-03, 5/20/2002, §2)

§21-203. Permit Procedures.

1. A permit must be acquired from New Britain Township for any work within a Township right-of-way and from the Pennsylvania Department of Transportation (PennDOT) for any work within a State right-of-way where such work involves construction or alteration of a driveway or installation of utility or other structures.
2. An application for a driveway permit shall be submitted in the name of the owner or equitable owner of the property.
3. An application for a road opening permit for utility installation must be submitted in the name of the owner or operator of the facility.
4. Forms, plans and fees shall be submitted in accordance with regulations and procedures adopted by either New Britain Township or PennDOT for work in Township or State rights-of-way, respectively. The application fees for work within Township rights-of-way shall be specified in the schedule of fees adopted by resolution by the Board of Supervisors.

STREETS AND SIDEWALKS

(Ord. 02-05-03, 5/20/2002, §3)

§20-204. Regulations and Standards.

1. This Part represents minimum requirements of certain types of activities within Township or State rights-of-way. Activities associated with approved subdivisions or land developments shall be subject to any additional requirements of the final plans as approved by New Britain Township and/or PennDOT. Any activity not regulated by the Subdivision and Land Development Ordinance [Chapter 22] of New Britain Township shall be regulated by requirements of these rules and regulations.
2. A drainage control plan and analysis shall be submitted whenever an increase in flow of water into a street or into existing drainage facilities will result from the proposed activity. The design of all drainage facilities shall be based on the Rational Method, as determined by the PennDOT Design Manual, Part 2, as amended, and the U.S. Department of Commerce, Hydraulic Design Series No. 5, Hydraulic Design of Highway Culverts, as amended.
3. All construction work, structures, paving and facilities shall conform to the design standards of PennDOT publications 408 and 72 (Road Construction Standards), as amended. Work shall be done at such time and in such a manner as shall be consistent with the safety of the public. Any work within Township or State rights-of-way shall conform to all requirements and standards of PennDOT except as otherwise supplemented or modified by these rules and regulations. In the event regulations conflict, the most stringent regulations shall apply. If, at any time, it is found the work is not being done or has not been properly performed, the permittee, upon being notified, in writing, by either the Township or PennDOT, may immediately take the necessary steps, at its own expense, to replace the work in a condition to conform to such requirements or standards. In case any dispute arises between the permittee and the representative of the owner of the right-of-way, the owner's representative shall have the authority to suspend work until the question at issue can be decided by the Township and/or State.
4. The following PennDOT provisions shall regulate the occupancy of all Township and State rights-of-way, unless otherwise required by an approved subdivision or land development plan, the Township Engineer or PennDOT officials:
 - A. Pennsylvania Code, Title 67 Transportation, Chapter 441 Access and Occupancy of Highways by Driveways and Local Roads, as amended.
 - B. Pennsylvania Code, Title 67 Transportation, Chapter 459 Occupancy of Highways by Utilities, as amended.
5. A traffic control plan must be submitted to either close any portion of a travel lane during construction, during the hours of darkness when no active work is in progress or to detour traffic in order to perform the permitted work. All plans shall

conform with §6123 of the Motor Vehicle Code, as amended, and the applicable provisions of Pennsylvania Code, Title 67 Transportation, Chapter 203, as amended.

(Ord. 02-05-03, 5/20/2002, §4)

§21-205. Driveway Construction Requirements.

1. Driveways shall be located at least 40 feet from street intersections, measured from the centerline of the driveway to the point of intersection of the street ultimate right-of-way lines (extended). When streets of different classifications are involved, driveways shall provide access to the street of lesser classification.
2. Driveways shall be provided with a stopping area of 20 feet, at a maximum grade of 3%, measured from the edge of cartway. In order to provide access for emergency vehicles, the maximum centerline grade for any portion of the driveway shall not exceed 8% and the maximum change in grade shall not exceed 6%.
3. Driveways shall be paved for a minimum of 50 feet from the edge of the street or to the ultimate right-of-way, whichever is greater. The pavement construction shall be in accordance with the attached construction detail.¹ In the event additional width or a supplemental thickness is required by other rules and regulations of the Township or PennDOT or as may be necessitated by site conditions, these minimum requirements shall be increased appropriately.
4. Driveways shall have a minimum radius of curvature at the street intersection of 10 feet.
5. A minimum distance of five feet shall be maintained between the driveway and the side lot lines.
6. Driveways shall have a minimum turnaround area of 10 feet by 20 feet.
7. A fifty-foot clear sight triangle must be provided for all driveways, measured from the point of intersection of the street right-of-way line and edge of the driveway. The site plan shall contain a notation that states that the applicant is required to maintain the area of the clear sight triangle and the Township has the right to enter and perform required maintenance in the area if deemed critical to public welfare.
8. Sight distances for all driveways shall comply with Pennsylvania Code, Title 67 Transportation, Chapter 441 Access and Occupancy of Highways by Driveways and Local Roads, as amended.

¹ Editor's Note: Construction detail is on file and may be seen at the Township office.

STREETS AND SIDEWALKS

9. When a sidewalk is proposed across a driveway, a concrete apron shall be installed in accordance with the attached construction detail.² When a curb is proposed along a driveway, depressed curb shall be installed in accordance with the attached construction detail.
10. A fifteen-inch RCP culvert, or equivalent size, shall be provided for all driveways. The minimum culvert length shall be 24 feet, with flared end sections and end-walls. Where an existing roadside drainage swale is too shallow to permit installation of a driveway culvert, a concrete trench box with grate may be utilized upon approval of the Township.
11. Any associated grading, curb or sidewalk installation located within the street right-of-way shall be in accordance with the design standards of the Township's Subdivision and Land Development Ordinance [Chapter 22], as amended.

(Ord. 02-05-03, 5/20/2002, §5)

§21-206. Utility Installation Requirements.

All utility installation and pavement trench restoration shall be in accordance with the attached construction details.¹

(Ord. 02-05-03, 5/20/2002, §6)

§21-207. Maintenance Period.

Upon completion of the work authorized by the permit, the Township shall inspect the work and when necessary, enforce compliance with the conditions, restrictions and regulations prescribed by the Township. In addition to such inspection, the Township may reinspect the work not more than two years after its completion and if any settlement of the road surface or other defects shall appear in the work contrary to the conditions, restrictions and regulations of the Township, it may enforce compliance therewith. If the applicant shall fail to rectify a defect which presents an immediate or imminent safety or health problem in 48 hours or any other defect within 60 days after written notice from the Board of Supervisors to do so, the Board of Supervisors or its agents may do the work and impose upon the applicant the costs thereof together with an additional 20% of the costs, which may be recovered by a civil action in the Court of Commons Pleas of Bucks County.

(Ord. 02-05-03, 5/20/2002, §7)

² Editor's Note: Construction detail is on file and may be seen at the Township office.

§21-208. Guidelines for Maintaining and Operating Traffic Signals.

1. If any contractor performing work in New Britain Township damages, knocks down, or otherwise causes a failure to any traffic signal equipment located in the Township, the contractor shall be responsible for the repairing, replacing or resetting of any traffic signal equipment damaged or disturbed in accordance with the following requirements:
 - A. Immediately (within one hour) alert New Britain Township Police Department of any and all damages, and identify the type of repair permitted as stated and according to PennDOT Publication 191, Exhibit 3.2: Response Maintenance Schedule, which identifies the types of repairs permitted and not permitted for various knockdowns and failures.
 - B. Provide emergency or final repair (within four hours) related to damage, knockdown, or cause failure in accordance with PennDOT Publication 191, Exhibit 3.2: Response Maintenance Schedule.
 - C. In the event temporary repair is provided in-lieu-of emergency or final repair, final or permanent repair must be provided within one calendar week of damages or notice of delay must be provided to the Township with said time frame along with information regarding the estimated time for completion of final repair along with an explanation of delay.
 - D. If defects cannot be satisfactorily repaired or corrected to Township satisfaction within one calendar week, contractor shall provide reimbursement for any expenses incurred by New Britain Township for repairs.
 - E. For long-term traffic signal outages where flashing mode is not possible, an alternative traffic control method must be coordinated with PennDOT Engineering District 6-0 and the New Britain Township staff.

(Ord. 02-05-03, 5/20/2002; as added by Ord. 2012-07-01, 7/16/2012, §I)

§21-209. Penalties.

1. Enforcement Remedies.
 - A. Any person, partnership or corporation who or which has violated or permitted the violation of the provisions of this Part shall, upon being found liable therefor in a civil enforcement proceeding commenced by the Township, pay a judgment of not more than \$1,000 plus all court costs, including reasonable attorney fees incurred by the Township as a result thereof. No judgment shall commence or be imposed, levied or payable until the date of the determination of a violation by the Magisterial District Judge. If the defendant neither pays nor timely appeals the judgment, the Township may enforce the judgment pursuant to the applicable rules of civil procedure. Each day that a violation

STREETS AND SIDEWALKS

continues or each Section of this Part which shall be found to have been violated shall constitute a separate offense.

- B. Nothing contained in this Section shall be construed or interpreted to grant to any person or entity other than the Township the right to commence any action for enforcement pursuant to this Section.
- C. Magisterial District Judges shall have initial jurisdiction over proceedings brought under this Section.

(Ord. 02-05-03, 5/20/2002, §8; as amended by Ord. 2007-02-01, 2/12/2007; and by Ord. 2012-07-01, 7/16/2012, §II)

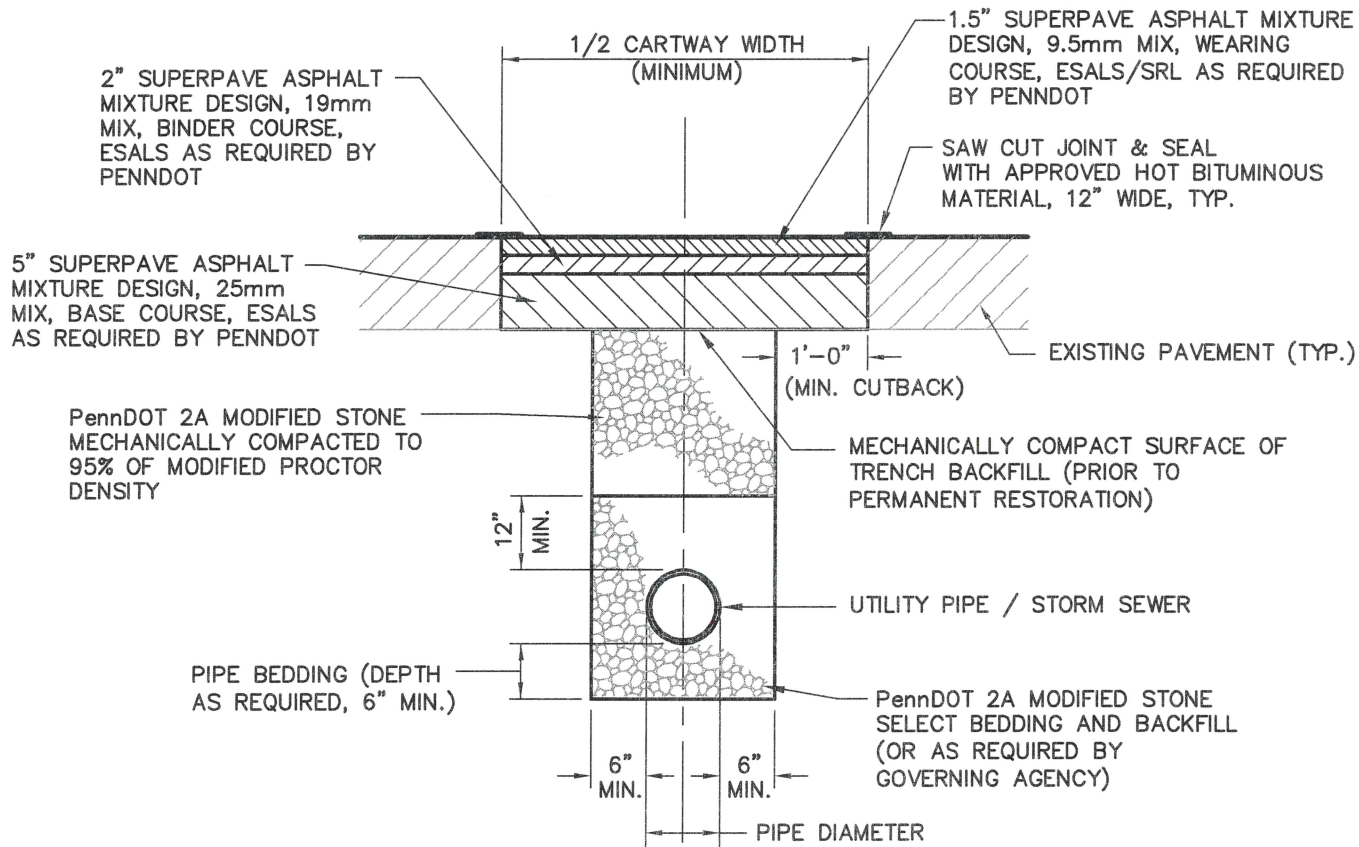

AFTER 90 DAYS RESTORATION

NOTES:

1. BEFORE 90 DAYS, ROADS SHALL BE TEMPORARILY RESTORED WITH 2A COURSE AGGREGATE AND 2" OF PENNDOT BINDER COURSE (TO GRADE) AND ALLOWED TO SETTLE 90 DAYS PRIOR TO PERMANENT RESTORATION, AS SHOWN ABOVE. PERMANENT RESTORATION OF TRENCHES SHALL BE COMPLETED ONLY AFTER APPROVAL BY TOWNSHIP ENGINEER.
2. RETAINED SUITABLE MATERIAL MAY BE USED AS BACKFILL FOR TRENCHES IN TOWNSHIP RIGHT-OF-WAY (OUTSIDE OF CARTWAY) WHEN MORE THAN THREE (3) FEET FROM EDGE OF EXISTING CARTWAY, CURB, AND/OR SIDEWALK.
3. THE MINIMUM WIDTH OF PAVEMENT RESTORATION SHALL BE 1/2 OF THE CARTWAY WIDTH. IN AREAS WHERE THE TRENCH CROSSES THE CENTERLINE OF THE CARTWAY, THE ENTIRE CARTWAY WIDTH (CURB TO CURB OR EDGE TO EDGE) OF THE AFFECTED STREET SHALL BE MILLED AND REPAVED WITH WEARING COURSE, UNLESS OTHERWISE APPROVED BY TOWNSHIP PUBLIC WORKS.
4. COLD PATCH SHALL BE APPLIED ON ALL TRENCH RESTORATIONS (PRIOR TO 90 DAYS) WHEN BINDING OR BASE COURSE ARE NOT AVAILABLE DUE TO WEATHER CONDITIONS.
5. FOR PLASTIC UTILITIES, INSTALL DETECTION TAPE OVER PIPE AT TOP OF STONE BACKFILL.

STORM SEWER & UTILITY TRENCH RESTORATION WITHIN PAVED AREAS DETAIL

NEW BRITAIN TOWNSHIP, BUCKS COUNTY, PENNSYLVANIA



GILMORE & ASSOCIATES, INC.
ENGINEERING & CONSULTING SERVICES

65 EAST BUTLER AVENUE, SUITE 100, NEW BRITAIN, PA 18901-5106 • (215) 345-4330
 www.gilmore-assoc.com

DATE:
5/22/09

LAST REVISED:
07/01/24

SCALE:
N.T.S.

DRAWING No:

5 OF 22

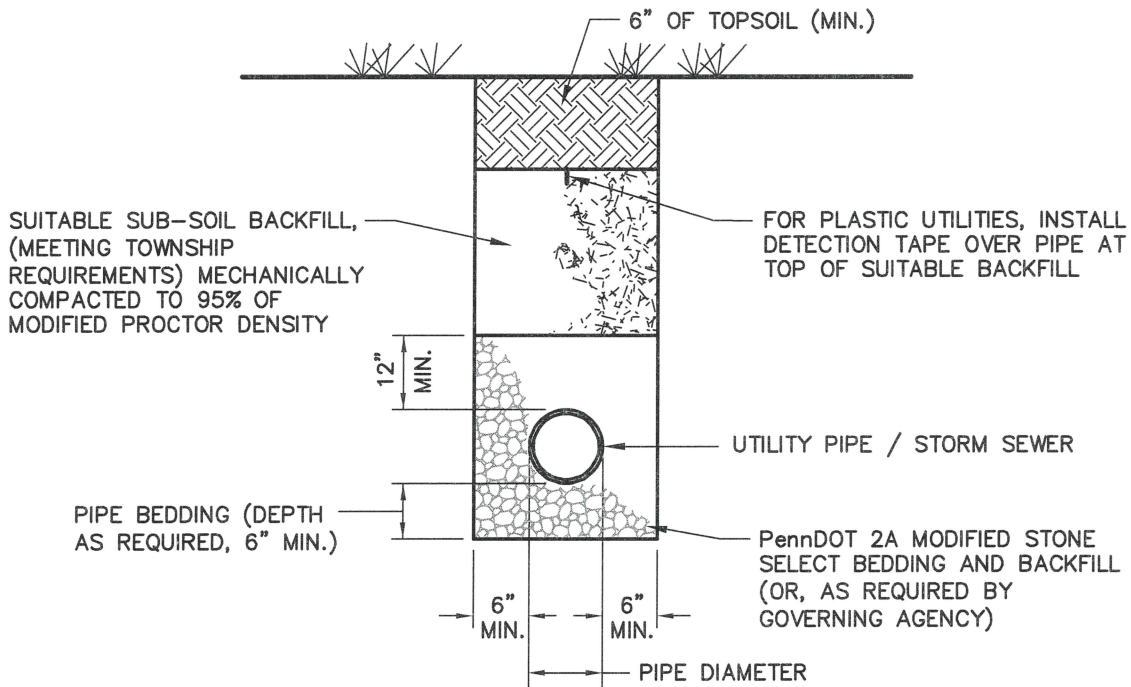

STORM SEWER & UTILITY TRENCH RESTORATION WITHIN PVIOUS AREAS DETAIL

NEW BRITAIN TOWNSHIP, BUCKS COUNTY, PENNSYLVANIA



GILMORE & ASSOCIATES, INC.
ENGINEERING & CONSULTING SERVICES

65 EAST BUTLER AVENUE, SUITE 100, NEW BRITAIN, PA 18901-5106 • (215) 345-4330
www.gilmore-assoc.com

DATE:
5/22/09

LAST REVISED:

SCALE:
N.T.S.

DRAWING No:

6 OF 22

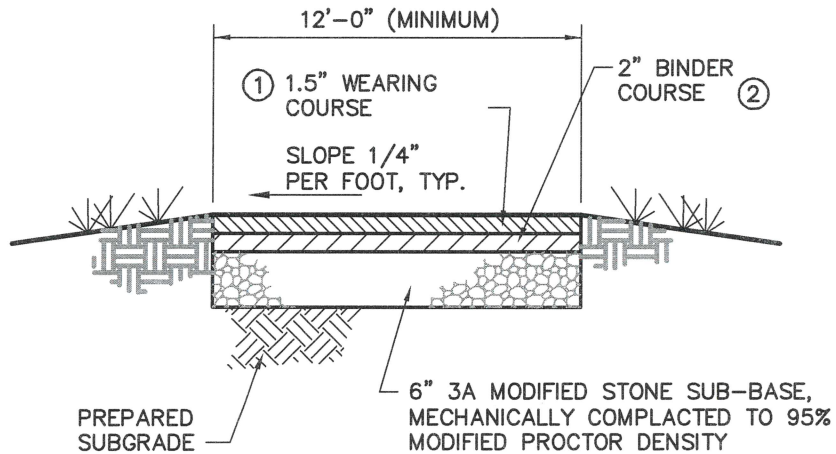

MINIMUM SPECIFICATION

- ① 1.5" SUPERPAVE ASPHALT MIXTURE DESIGN, 9.5 mm WEARING COURSE
- ② 2.0" SUPERPAVE ASPHALT MIXTURE DESIGN, 19mm MIX BINDER COURSE

**RESIDENTIAL DRIVEWAY
PAVING SECTION DETAIL**

NEW BRITAIN TOWNSHIP, BUCKS COUNTY, PENNSYLVANIA



GILMORE & ASSOCIATES, INC.
ENGINEERING & CONSULTING SERVICES

65 EAST BUTLER AVENUE, SUITE 100, NEW BRITAIN, PA 18901-5106 • (215) 345-4330
www.gilmore-assoc.com

DATE: 5/22/09	LAST REVISED: 8/16/22	SCALE: N.T.S.	DRAWING No: 7 OF 22
------------------	--------------------------	------------------	------------------------

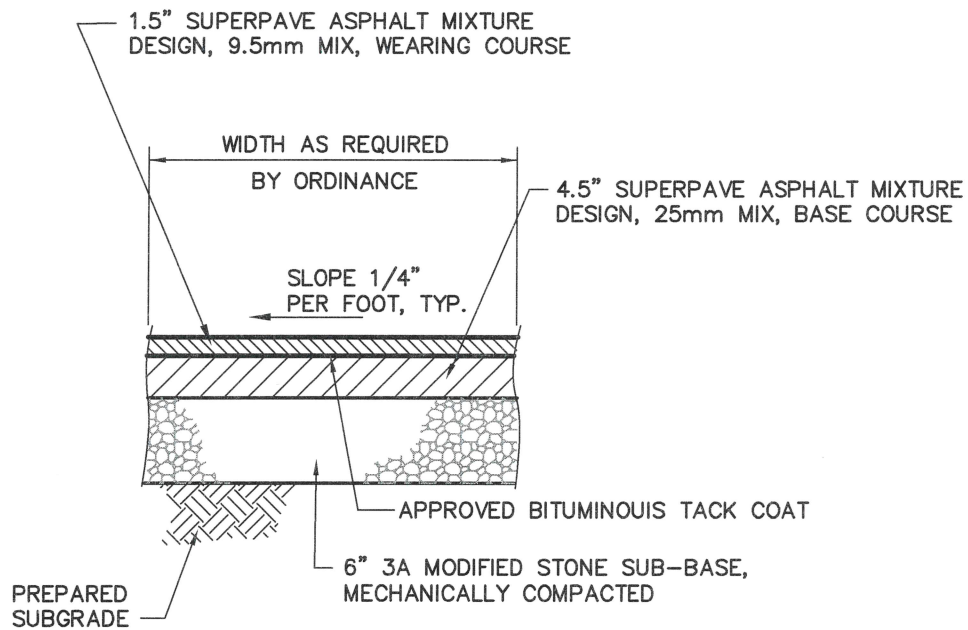

**NON-RESIDENTIAL AND MULTI-RESIDENTIAL DRIVEWAYS,
PARKING AREAS AND LOADING AREAS
PAVING SECTION DETAIL**

NEW BRITAIN TOWNSHIP, BUCKS COUNTY, PENNSYLVANIA



GILMORE & ASSOCIATES, INC.
ENGINEERING & CONSULTING SERVICES

65 EAST BUTLER AVENUE, SUITE 100, NEW BRITAIN, PA 18901-5106 • (215) 345-4330
www.gilmore-assoc.com

DATE:
5/22/09

LAST REVISED:

SCALE:
N.T.S.

DRAWING No:

8 OF 22

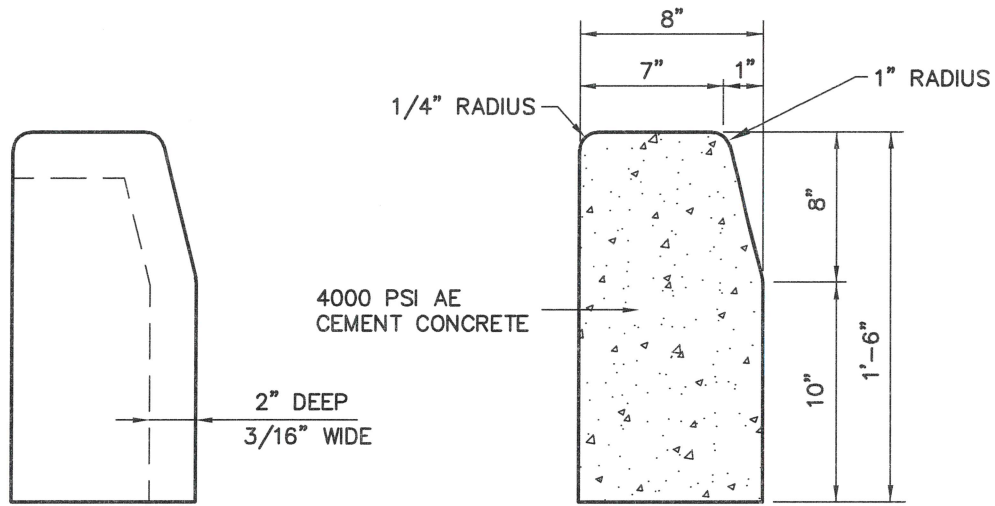

CONTRACTION JOINT

TYPICAL CROSS SECTION

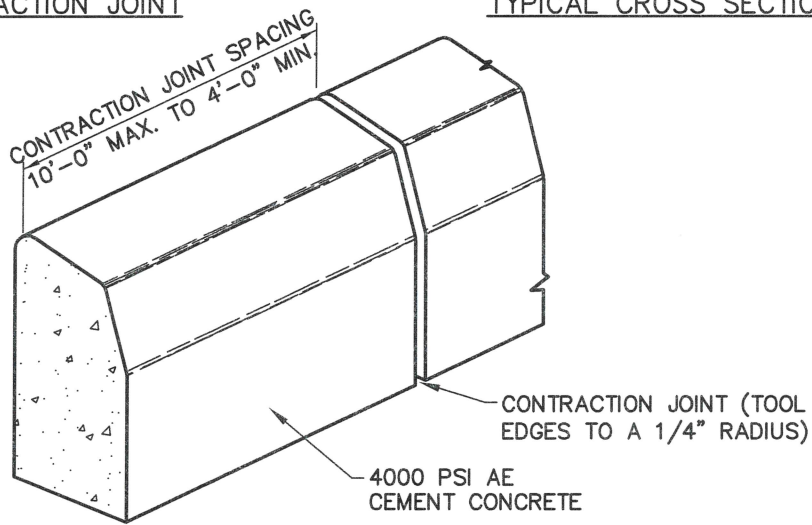

NOTES:

1. PLACE 1/2" PREMOLDED EXPANSION JOINT MATERIAL EVERY 50 FEET (MAX.) AND AT ALL DRIVEWAYS (DEPRESSED CURB CUTS), INLETS, AND CURB RADII.
2. MINIMUM 2-#6 REINFORCING BARS PER SIDE WHERE CURB ABUTS INLET HOODS, INCLUDING PREMOLDED EXPANSION JOINT MATERIAL.
3. WHERE CURB ARE INSTALLED BY A MACHINE, SAW CUTS SHALL BE 2" DEEP, EVERY 10 FEET.

PLAIN CEMENT CONCRETE CURB DETAIL

NEW BRITAIN TOWNSHIP, BUCKS COUNTY, PENNSYLVANIA



GILMORE & ASSOCIATES, INC.
ENGINEERING & CONSULTING SERVICES

65 EAST BUTLER AVENUE, SUITE 100, NEW BRITAIN, PA 18901-5106 • (215) 345-4330
 www.gilmore-assoc.com

DATE:
5/22/09

LAST REVISED:

SCALE:
N.T.S.

DRAWING No:

9 OF 22

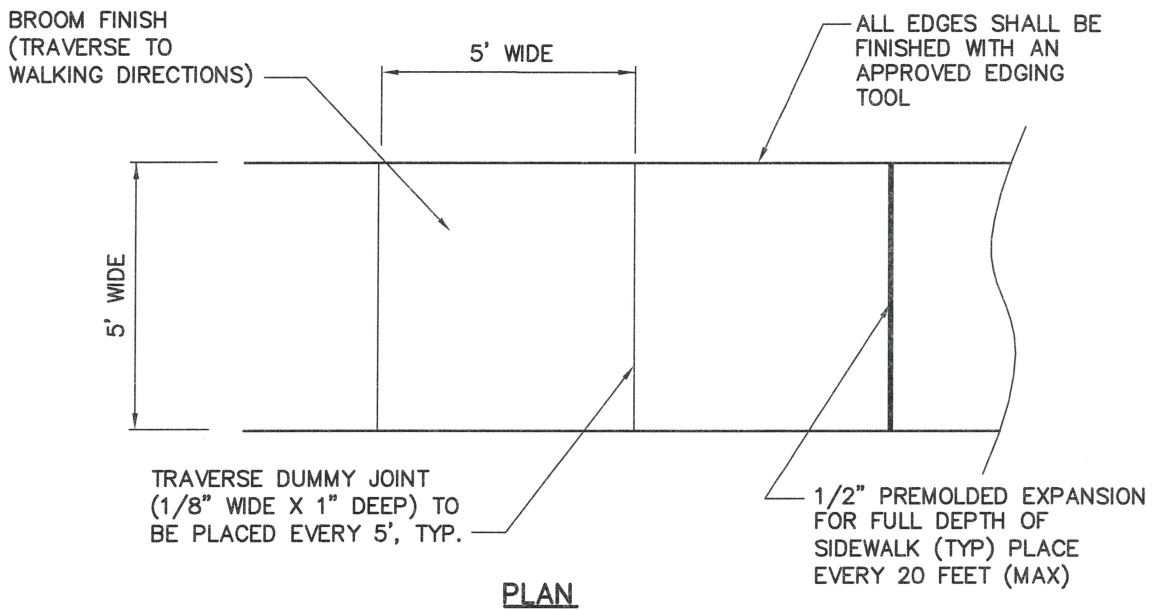
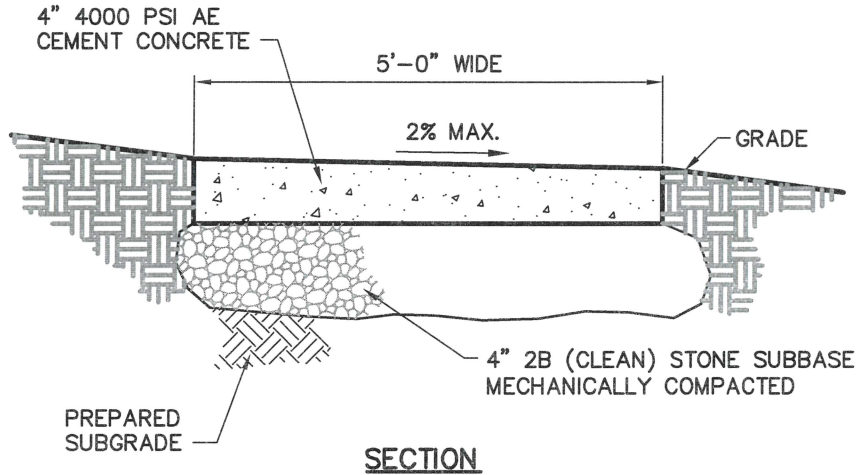

NOTES:

1. WITH ALL PROPOSED SIDEWALK, A NON-SLIP SURFACE TEXTURE SHALL BE BROOMED TRAVERSE TO THE SLOPE OF THE SIDEWALK.
2. ALL SIDEWALK SHALL BE IN ACCORDANCE WITH ACI & TOWNSHIP STANDARDS.

CONCRETE SIDEWALK DETAIL

NEW BRITAIN TOWNSHIP, BUCKS COUNTY, PENNSYLVANIA



GILMORE & ASSOCIATES, INC.
ENGINEERING & CONSULTING SERVICES

65 EAST BUTLER AVENUE, SUITE 100, NEW BRITAIN, PA 18901-5106 • (215) 345-4330
 www.gilmore-assoc.com

DATE:
5/22/09

LAST REVISED:

SCALE:
N.T.S.

DRAWING No:

11 OF 22

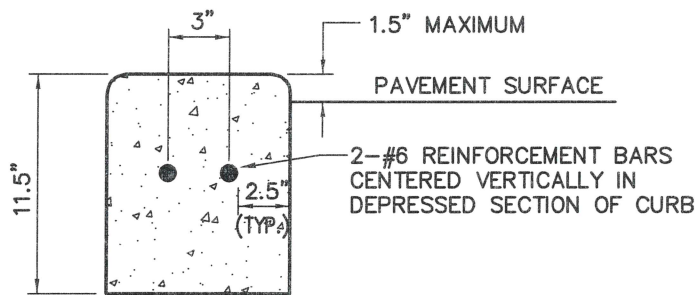

SECTION A-A

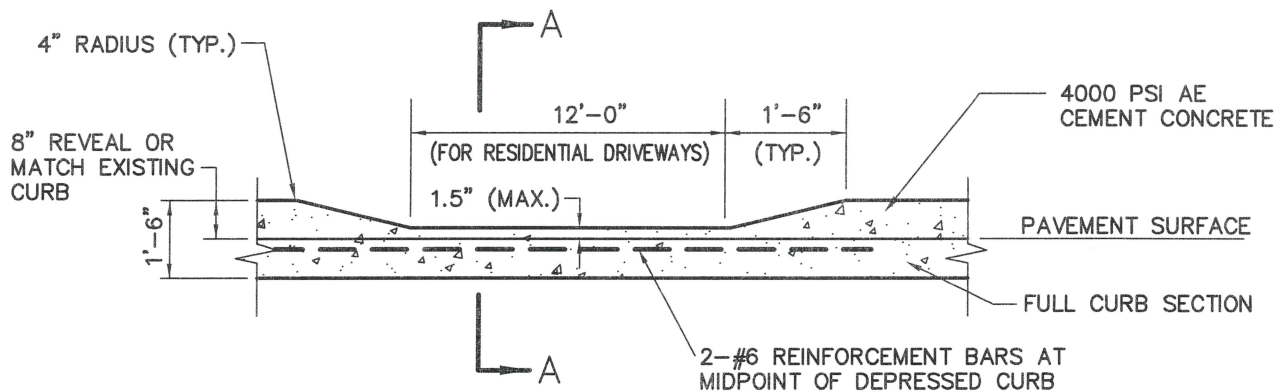

DEPRESSED CURB DETAIL

NEW BRITAIN TOWNSHIP, BUCKS COUNTY, PENNSYLVANIA



GILMORE & ASSOCIATES, INC.
ENGINEERING & CONSULTING SERVICES

65 EAST BUTLER AVENUE, SUITE 100, NEW BRITAIN, PA 18901-5106 • (215) 345-4330
www.gilmore-assoc.com

DATE:
5/22/09

LAST REVISED:

SCALE:
N.T.S.

DRAWING No:

12 OF 22

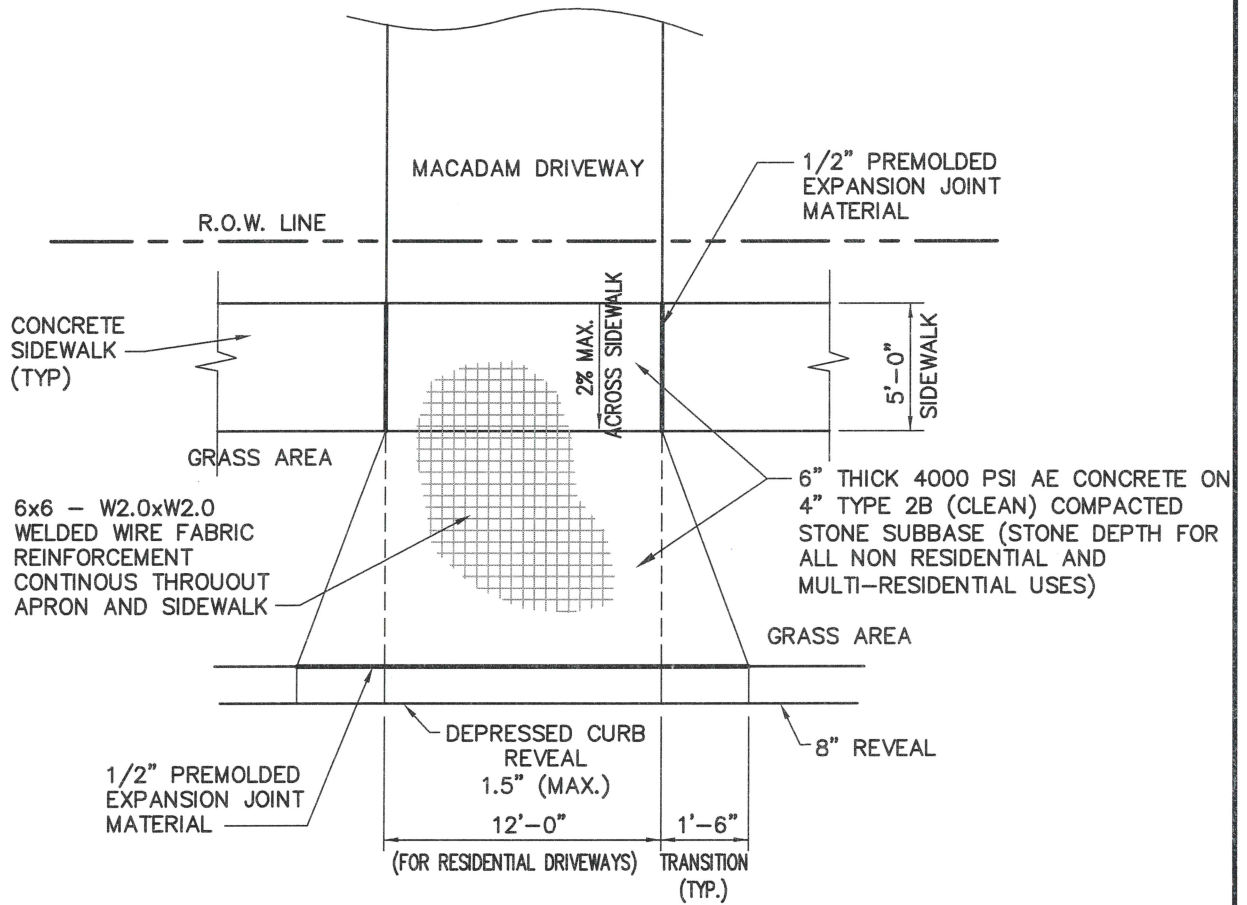

DRIVEWAY AND APRON DETAIL

NEW BRITAIN TOWNSHIP, BUCKS COUNTY, PENNSYLVANIA



GILMORE & ASSOCIATES, INC.
ENGINEERING & CONSULTING SERVICES

65 EAST BUTLER AVENUE, SUITE 100, NEW BRITAIN, PA 18901-5106 • (215) 345-4330
 www.gilmore-assoc.com

DATE:
5/22/09

LAST REVISED:

SCALE:
N.T.S.

DRAWING No:

13 OF 22